

SILVIA SCHAEFFER

— INTERIOR DESIGN —



COMMERCIAL | *RESIDENTIAL*
sophistication for every space

about

Silvia Schaeffer

Silvia Schaeffer is Brazilian, born in São Paulo, with more than 19 years of experience in Architecture and Interior Design. Silvia has a wide range of impeccably executed projects in both Brazil and the USA, where she has lived since 2016, running her own office dedicated to Architectural and Interior Design projects for Residential and Commercial clients.

Silvia considers herself an Interior Designer of the soul. It's not just about putting things in a room. It is much deeper and wider. It's about self discovery. Silvia's top priority is always to understand everything about her clients, their personalities, hobbies, and lifestyle, so she can make sure she customizes her design ideas to fit perfectly with their taste and needs.

"I'm passionate about great design, aligned with functionality, respecting the clients vision with a touch of Brazilian flair. Each of my projects is the perfect combination of quality and creativity."

Silvia's skills include: Interior Design, Landscape Design, Lighting Design, Floor Plan Design, Project Management, and Staging.

"I take over everything, from an idea and concept development to realization. I believe in traditions and incorporate them within my innovations. All my projects incorporate a unique artistic image and functional solutions. The client is the soul of the project."

Silvia's goal is to provide a great interaction with her clients by understanding their needs and translating their desires into a custom design experience that will exceed their expectations.

Continuing to use her gifts to help others love their spaces and bring joy to their homes & lives.

"I'm passionate about great design, aligned with functionality, respecting the clients vision with a touch of Brazilian flair. Each of my projects is the perfect combination of quality and creativity." —Silvia



content



10 Bar & Lounge
Contemporary bar project.

COMMERCIAL

06

Taylor Made Office

Warehouse remodeled to industrial modern design.

08

Z Street Loft

Colors and landscape design for brand new apartment building.

12

Beauty Studio

Modern lines and beautiful details to enhance client's rebrand.

Hills House
Home using modern style
while mixing materials.

14

Photographer House
New build with modern lines
and clean design.

16

2 Creeks House
Custom designed home,
following a transitional
design approach.

18

Lake View House
Presenting elegance at
it's best with a modern
home interior.

20

Boulevard House
Efficient, modern and
inviting kitchen.

22

Tree House
Clean and elegant design
using minimal color and
displays.

23

Modern Apartment
New apartment with a
new layout design.

24

Kids Playroom
New furniture and materials
with a modern and clean design.

25

White House
Contemporary home remodeled
following modern lines, clean
design, and open spaces.

26

Camas House
New furniture and design
for a new construction home.

36



28 Troy House Bedrooms
Modern bedrooms for everyone
in the family.



32 Troy House Basement
Function and fun doesn't take
a back seat to modern design.



34 Portland Condo
Cohesive design for a modern
lifestyle.



OFFICE
TAYOR MADE

COMMERCIAL
design



Silvia has extensive experience with commercial jobs (hotels, lounges, restaurants, retail spaces, offices, libraries, schools, country clubs, gyms, spas and shopping malls), with a focus to increase functionality and elevate style for financial gain.

Experience in commercial interior design consists of: Layout and Floor plan; Furniture rearrangement / replacement; Color palette and finishing selection; Wall textures and materials; Kitchen design; Bathroom design; Lighting; and Landscaping.



INDUSTRIAL MODERN

An old warehouse office completely remodeled to an industrial modern design concept.





Z STREET LOFT

For this brand new apartment building Silvia provided finishing colors, signs and landscape design.



"I loved working with Silvia and seeing the final work of my home. She easily understood what we intended by doing the bathroom and home exterior renovation project. Loved the mix of colors and materials both indoors and outdoors. It was beautiful... recommend!" —Antonia M.





BAR & LOUNGE

An old Bar & Lounge in the center of Detroit where Silvia designed a contemporary project, integrating the bar area with the dancing and dinner spaces. The ceiling lights in the dance area gives you rooftop feelings.







BEAUTY STUDIO

The client wanted to bring more life into the studio to make her customers warm and cozy.

Modern lines and custom details to make more impressive for her rebrand. When the clients arrive in the space, they could really stand out with high-end, quality. Her physical location needs to match the new, evolved brand.



Having extensive experience with residential jobs (single family homes, condos, apartments, vacation homes), Silvia's innovative design consistently impresses her clients.

Projects may include: Remodeling of existing homes; New construction support; Layout and Floor plan; Furniture rearrangement / replacement; Color palette and finishing selection; Wall textures and materials; Kitchen design; Bathroom design; Lighting; and Landscaping.



MODERN MIXING

For this renovation I followed the house's modern style mixing materials.





HILLS HOUSE

RESIDENTIAL design





PHOTOGRAPHER HOUSE

New construction house of a modern family with three kids. We replaced furniture and followed modern lines and clean design to receive family and friends.





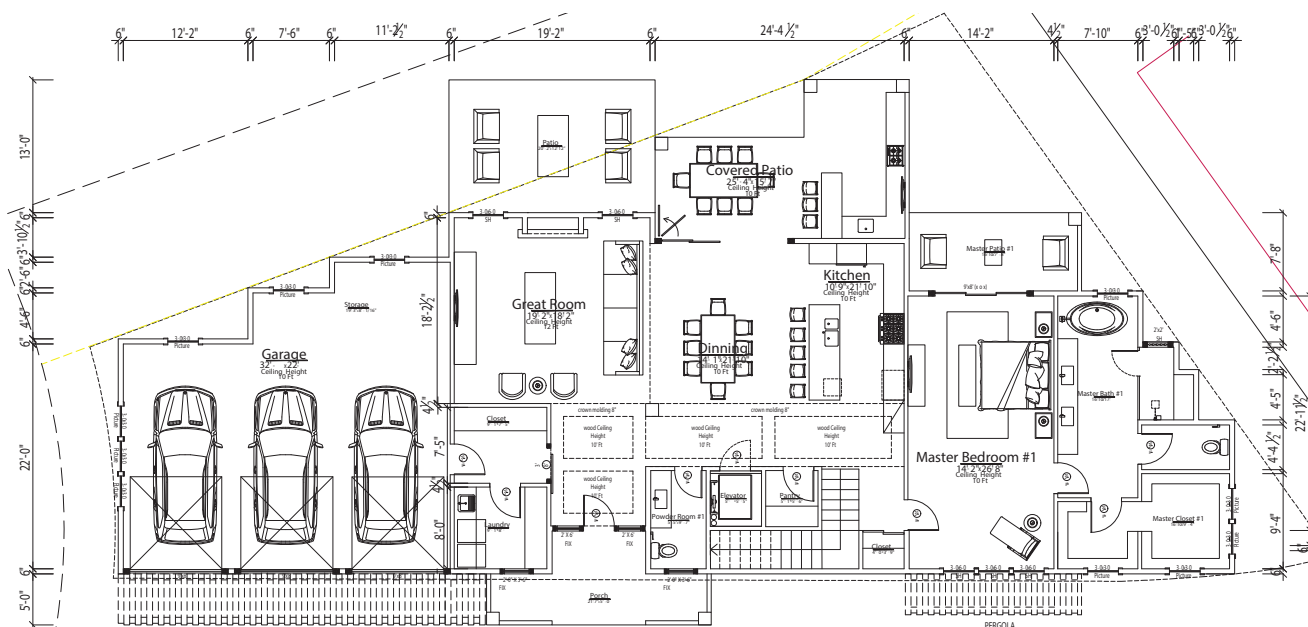

2 CREEKS HOUSE: IN PROGRESS

This exclusive 4,000+ sq. ft. custom designed home was tailored to follow the existing residential development style, but also incorporate the client's specific needs. This one is a special lot with a unique personality and a traditional design approach.

*"Silvia is attentive and takes
your style into consideration.
She steps up and delivers.
Thank you!" —Gleice J.*





LAKE VIEW HOUSE

Presenting elegance at its best with a modern home interior. This design should point out that less is truly more if you know how to organize your space. Simple but beautiful art pieces, a lot of natural sunlight as well as natural elements throughout the object and minimal decor elements come together to create this amazing yet simple design.



EVOLUTION WITH SIMPLICITY
AND MODERNITY



BOULEVARD HOUSE

The clients required a whole new design of their kitchen. Besides being dated and not having enough light, the biggest challenge was to create a better circulation flow without compromising the powder room.

The result was a well-planned and very efficient kitchen with a modern and inviting feel.





TREE HOUSE

The geometric play with lighting, house elements and varied surfaces is excellent. The minimal color palette makes for a very clean and elegant design.





MODERN APARTMENT

For a cool and modern family, this new apartment needed a new layout design and new furniture to make the atmosphere perfect.



KIDS PLAYROOM

Two adorable little girls knew what they liked for this space. With a modern and clean design, this playroom turned out to be their preferred space in the house.





WHITE HOUSE

A contemporary mid-century home from the late 60's that has been completely remodeled following modern lines, clean design and open spaces to receive family and friends.

Step inside the 3,176-square-foot home and you'll find a designer's dream with features inspired by mid-century modern architecture. The space is wide open—with the dining room just a single step up—and bay windows looking out to the front yard that admit ample natural light. The glass railing leading upstairs is another way to signal that little is concealed on the main floor.







TROY HOUSE

BOY'S ROOM

A modern boy's room with distinct spaces to sleep, play, read, and study. The bay window was the perfect spot for a functional storage bench while still being a fun, cool spot to read a book or play with toys.



▲ A ROOM TO GROW
The built in shelves next to the large desk allow for displaying trophies and special toys.

GIRL'S ROOM

A room fit for a princess-sized imagination. Parents and kids can both have it all when you combine creativity, functionality, and timeless modern lines.



DREAM COME TRUE
Every inch is designed
to inspire a childhood
bedroom full of happy
memories.





MASTER BEDROOM

Everyone in the Troy family has sweet dreams with their new bedrooms. For the master bedroom, a simple, elegant, and dark palette create a sophisticated mood. Every line is designed to flow together with elements that match other rooms in the house. The vanity and mirror add modern, fun highlights.



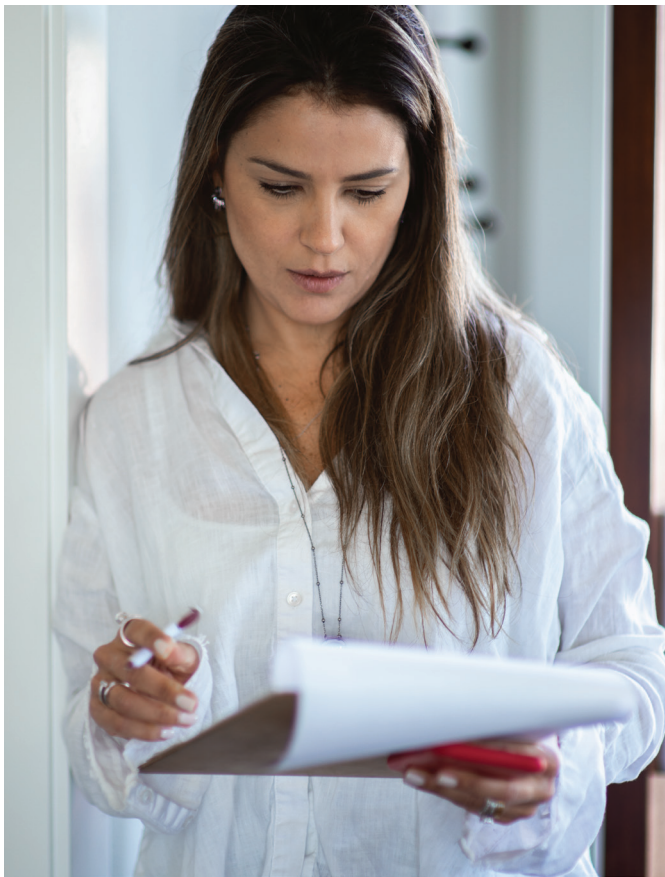

"I will never try do any interior designing myself again! Silvia has an amazing balance of creativity, great style, and project management. She included the whole family in the design process so everyone would love the outcome. After five years of living in our house, our space finally feels, and looks, like home." —Annie H.





BASEMENT

This basement has it all:
bar, atelier, bathroom,
and playroom,



EVERY STEP

The design begins
with the very first
step down the open
staircase.





Basements can be a wonderful way to express your style while adding multi-functional spaces for the whole family. No detail was overlooked. For instance, the tread lights help keep the ceiling high. The playroom has sliding barn doors allowing the adults to still be able to see the kids while not having to be in the same space. Nature is a design element that brings life and comfort into a space, perfect for a basement. Modern lines and unique details create a distinct personality in each room while keeping a cohesive feel to the entire basement. This is a space where everyone in the family wants to be.



▲ **WORK AND PLAY**
Sliding doors allow for a separated living space when you need it.





PORTLAND CONDO

The modern space features a view of the city of Portland, OR. A clean style with a mix of materials and textures fit the clients' desire to help keep the space feeling warm and inviting. The plants add life to the concrete and wood tones.





▲ WELCOME HOME
Every space in a home
is an opportunity to
showcase your style.





CAMAS HOUSE

A mix of clean lines and pops of color mix to create a home full of personality and fun. The use of wood materials adds a feeling of farm to table while the metal keeps the design modern. The wood beams offered a way to separate rooms without lowering the ceilings.





▲ COLOR
A muted color palette allows the purple doors to stand out without overwhelming the other elements of design.





You deserve a space
you want to show off!
A professional designer
can make all the difference.

Schedule
your consultation:

(248) 550-5663

info@silviaschaefferdesign.com

silviaschaefferdesign.com



SILVIA SCHAEFFER

Commercial | Residential
Interior Design





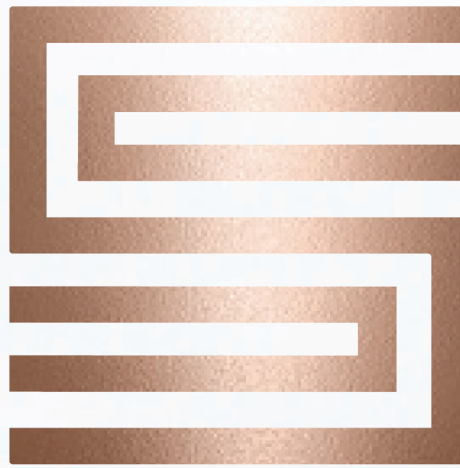

(248)-550-5663

info@silviaschaefferdesign.com

silviaschaefferdesign.com

